

STANDARD EXECUTIONS

Threaded pass-through hole.

- **GN 206:** cast iron, smooth finish, paintable.
- **GN 206-NI:** stainless steel fine-casting, sandblasted matte finish.

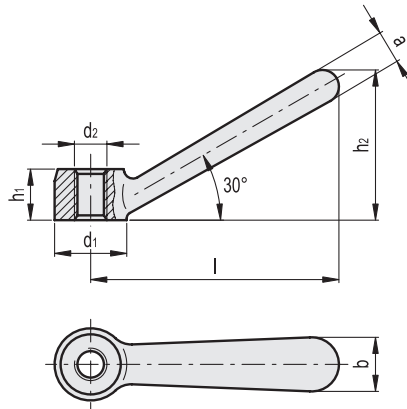

Conversion Table	
1 mm = 0.039 inch	
d1	
mm	inch
16	0.63
20	0.79
25	0.98
32	1.26
40	1.57

GN 206

METRIC

Code	Description	d1	d2	l	h1	h2	a	b	⚖
GN.21101	GN 206-16-M8	16	M8	56	12	34	7	12	38
GN.21111	GN 206-20-M10	20	M10	70	14	42.5	9	14	57
GN.21121	GN 206-25-M12	25	M12	87	18	53	11	18	128
GN.21131	GN 206-32-M16	32	M16	109	22	66.5	15	22	257
GN.21141	GN 206-40-M20	40	M20	140	28	84.5	18	28	518

GN 206-NI

INOX STAINLESS STEEL **METRIC**

Code	Description	d1	d2	l	h1	h2	a	b	⚖
GN.21102	GN 206-16-M8-NI	16	M8	56	12	34	7	12	30
GN.21112	GN 206-20-M10-NI	20	M10	70	14	42.5	9	14	60
GN.21122	GN 206-25-M12-NI	25	M12	87	18	53	11	18	125
GN.21132	GN 206-32-M16-NI	32	M16	109	22	66.5	15	22	248
GN.21142	GN 206-40-M20-NI	40	M20	140	28	84.5	18	28	518

Clamping levers